

5 52 087 063 00

fit Fitness trail shimmy station





made in germany

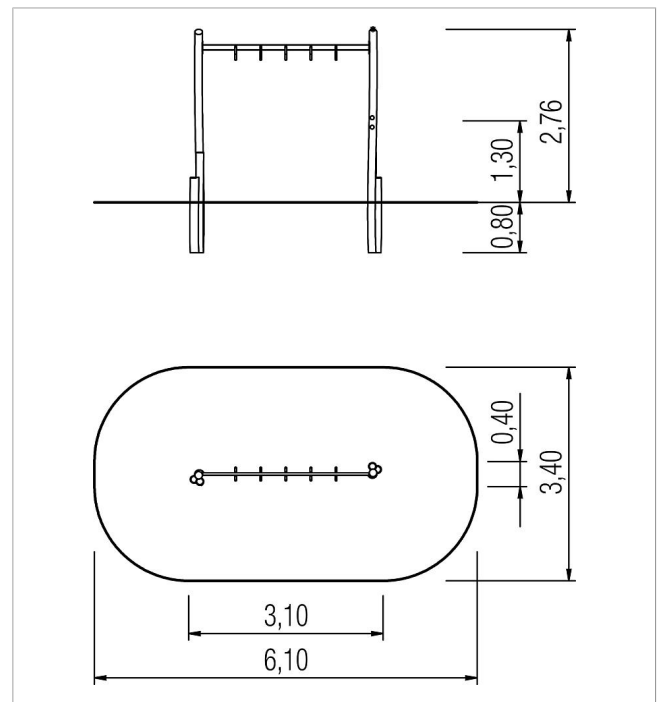

Scope of delivery

2x posts: robinia
1x horizontal ladder: stainless steel
4x post step: robinia
fittings: stainless steel



| | | |
|---|-----------------------|----------------------------------|
|  | Material | Robinia natural, stainless steel |
|  | Foundation level | FL 3 |
|  | Minimum space | 6,10x3,40x3,56 m |
|  | Free falling height | 130 cm |
|  | Impact protection net | 19,0 m ² |
|  | Foundations | 2x CF |
|  | Largest section | ø14x356 cm |